

RoHS

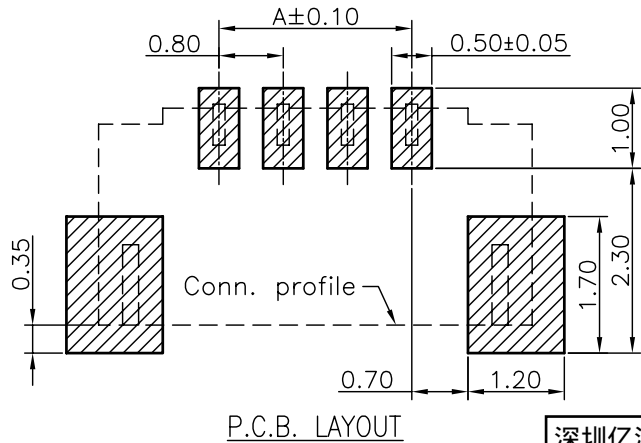

深圳亿沃鑫科有限公司
 TEL:+86135-901-78542
 FAX:+86-755-32932856
 www.ewconn.com

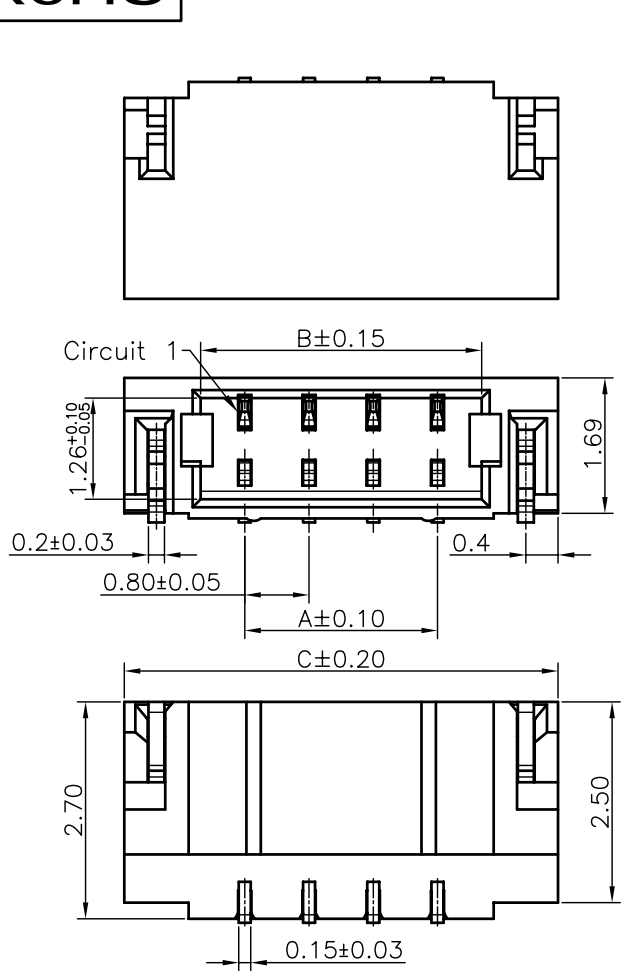
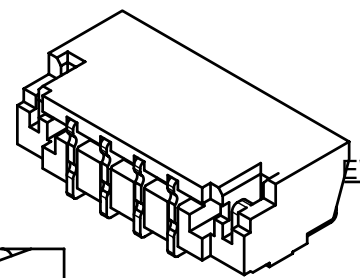

EWWB0800 W90-NPX-S-XX-XX

- ① Series No.
- ② W90 : Side Contact
W00 : Up Contact
- ③ No. of Circuits
- ④ A : Product color(A--Y)
Blank : Natural type
- ⑤ S: SMT Type
- ⑥ 5A: Pin Gold-flash
Solder Tabs Gold-flash
- ⑦ HF : Halogen Free

Dimensional Ordering Information:			
Circuits Part No	Dimensions		
	A	B	C
2P	1.90	3.80	
3P	1.60	2.70	4.60
4P	2.40	3.50	5.40
5P	3.20	4.30	6.20
6P	4.00	5.10	7.00
7P	4.80	5.90	7.80
8P	5.60	6.70	8.60
9P	6.40	7.50	9.40
10P	7.20	8.30	10.20
11P	8.00	9.10	11.00
12P	8.80	9.90	11.80
13P	9.60	10.70	12.60
14P	10.40	11.50	13.40
15P	11.20	12.30	14.20
16P	12.00	13.10	15.00
17P	12.80	13.90	15.80
18P	13.60	14.70	16.60
19P	14.40	15.50	17.40
20P	15.20	16.30	18.20
21P	16.00	17.10	19.00
22P	16.80	17.90	19.80
23P	17.60	18.70	20.60
24P	18.40	19.50	21.40

Specifications:
 Rated Voltage : 30V AC/DC
 Rated Current : 0.5A AC,DC
 Withstand Voltage : 200V AC/minute
 Contact Resistance : 30mΩ(MAX.)
 Insulation Resistance : 100MΩ(MIN.)
 Temperature Range : -25°C~+85°C

Part No.	Material	Color	Pin Material	Solder Tabs
WB0800W90-NP-S	Nylon 6T,UL94V-0	Beige	Phosphor Bronze/Matte Tin-plated	Brass/Matte Tin-plated
WB0800W90-NP-S-5A	Nylon 6T,UL94V-0	Beige	Phosphor Bronze/Gold-flash	Brass/Gold-flash
WB0800W90-NP-S-HF	Nylon 6T,UL94V-0	植/Beige	Phosphor Bronze/Matte Tin-plated	Brass/Matte Tin-plated
WB0800W90-NP-S-5A-HF	Nylon 6T,UL94V-0	植/Beige	Phosphor Bronze/Gold-flash	Brass/Gold-flash
WB0800W90-NPA-S-HF	LCP,UL94V-0	植/Black	Phosphor Bronze/Matte Tin-plated	Brass/Matte Tin-plated
WB0800W90-NPA-S-5A-HF	LCP,UL94V-0	植/Black	Phosphor Bronze/Gold-flash	Brass/Gold-flash
WB0800W90-NPA-S-5A-HF-NK	LCP,UL94V-0	植/Black	Phosphor Bronze/Gold-flash	Brass/Gold-flash

C6	12.04.21	新增黑色无卤不印字规格	龚友连	王志刚	一般公差 GENERAL TOLERANCE			绘图 DR.	陈干	EWCONNECTOR 深圳亿沃鑫科技有限公司	料号 PART NO. EWWB0800W90-NPX-S			
C5	12.02.27	4T无卤料改6T无卤料	龚友连	王志刚	X.X ±0.25	X' ±5'	校对 CHK.	龚友连	文件编号 NUMBER					
C4	11.08.15	HR1108150120	龚友连	王志刚	X.XX ±0.15	X.X' ±2'	审核 CHK.	龚友连	品名 TITLE			ENDE05		
C3	11.02.09	修改图面材质	龚友连	王志刚	X.XXX ±0.08	▲ MAJOR DIM.	核准 APPD.	王志刚	Pitch0.8 IDC R/A Wafer			比例 SCALE	SHEET	版次 REV.
版次 REV.	日期 DATE	变更内容 DESCRIPTION	审核 CHK.	核准 APPD.	单位 UNIT	mm						1/1	1/2	C6