

1	名称	材料
1	接触件	黄铜 (镀锡)
2	基座	LCP(U194-0)
3	焊片	磷青铜 (镀锡)

- A
- 1 `Current rating:1A AC/DC (AWG #26)
  - 2 `Voltage rating: 50V AC/DC
  - 3 `Temperature range: -25°C to 85°C
  - 4 `Contact resistance:Initial value/20mΩ max  
Electrical properties
  - 5 `Insulation resistance:100MΩ min
  - 6 `Withstanding voltage:500V AC/ minute
  - 7 `Applicable wire:AWG #30 to #26
- Environmental controls
- 1 `Banned contains SS - 00259 are restricted substances.
  - 2 `The corresponding issued by SGS or ITS ioc-aes data, Not the material in a list, and validity.

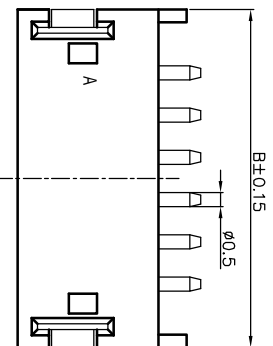
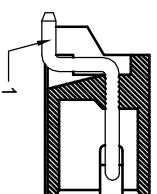
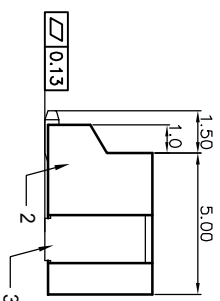
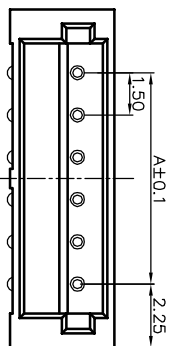
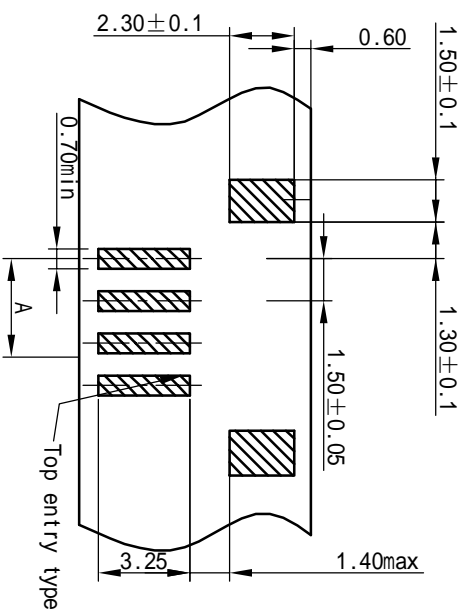

5	版本	日期	内容
	A1	08-05-01	

孔位 poles	A	B
2	1.50	6.00
3	3.00	7.50
4	4.50	9.00
5	6.00	10.50
6	7.50	12.00
7	9.00	13.50
8	10.50	15.00
9	12.00	16.50
10	13.50	18.00
11	15.00	19.50
12	16.50	21.0
13	18.00	22.5
14	19.50	24.0
15	21.00	25.5

一沃连接器  
Tel: +86-13590178542  
Fax: +86-755-32932856  
www.ewconn.com

<b>EWCONNECTOR</b> 深圳亿沃鑫科技有限公司		设计
尺寸公差	角度公差	品名: EW1502-WR-XXP
.X ±0.1	.X° ±0.1°	图号:
.XX ±0.05	.XX° ±0.05°	图号:
.XXX ±0.005	.XXX° ±0.005°	图号:
单位: mm	比例: --	页数: 1/1
		版本: A

1 2 3 4 5 6